

Drawn by Robert Maxtone Graham, 6 Moat Sole, Sandwich, Kent, in 1984; revised in 1998, 2002.

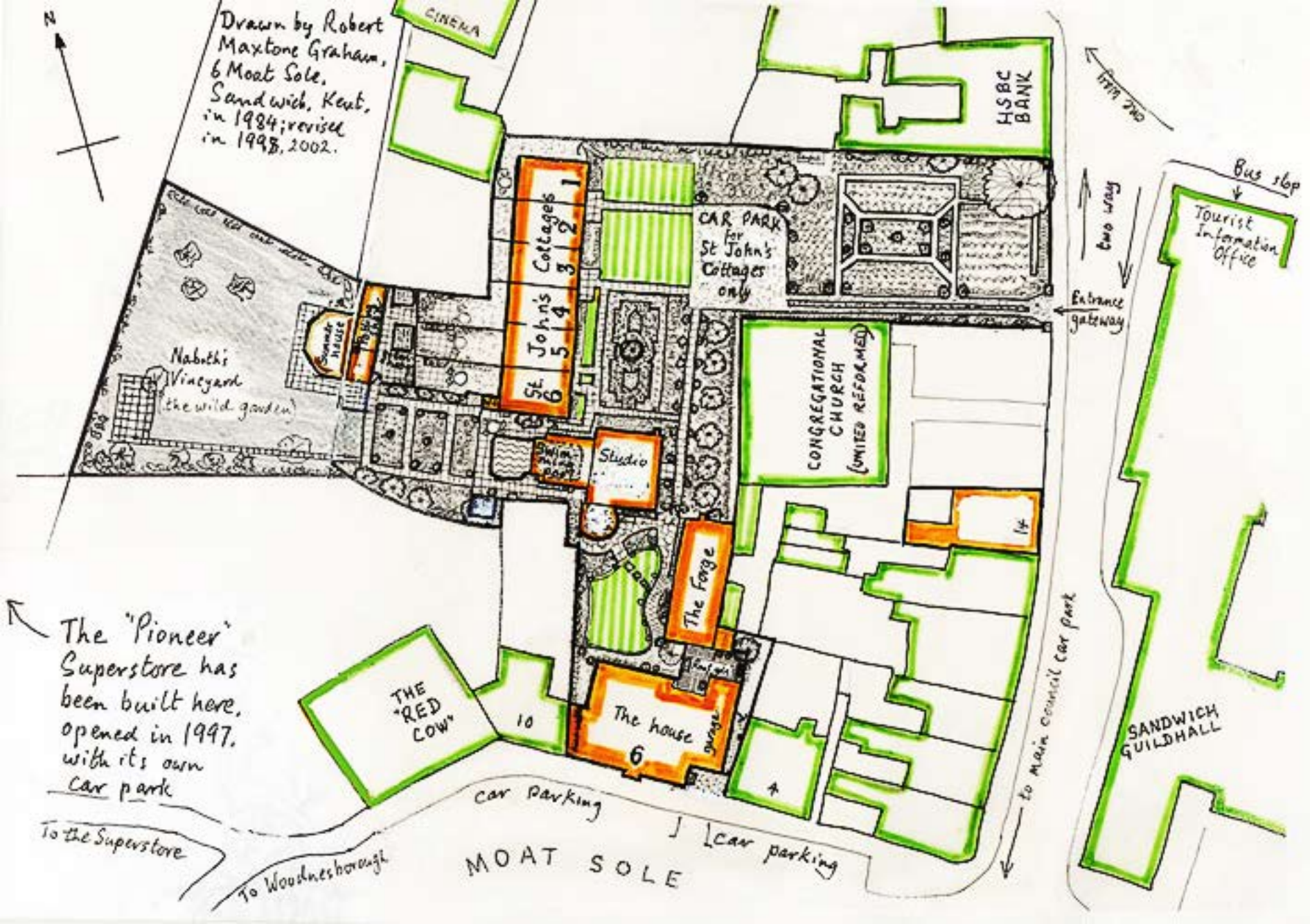

The "Pioneer" Superstore has been built here, opened in 1997, with its own car park

To the Superstore

To Woodnesborough

MOAT SOLE

car parking

car parking

to main council car park

Bus stop
Tourist Information Office
two way
Entrance gateway

SANDWICH GUILDHALL

HSBC BANK

St. John's Cottages
1
2
3
4
5
6

CAR PARK
for
St John's
Cottages
only

CONGREGATIONAL
CHURCH
(UNITED REFORMED)

Studio

The Forge

The house
6

THE
"RED
COW"

10

4

14

CINEMA

Naboth's
Vineyard
(the wild garden)

Summer
house

Tourist
Information
Office

two way

Entrance
gateway

Bus stop

1779 740

